



DGC 60°

Product Information Sheet

Standard Specification

Dimensions

Width/Depth/ (mm)	1180/1180/
Filling inlet diameter (mm)	350
Outlet diameter (mm)	250
Tare weight (kg)	See product range
Nominal capacity (L)	See product range

Composition

Liner	LMDPE ¹
Framework with anti-tilt bars	Mild Steel (galvanised)
Inlet / Seal	HDPE ² / SR ³
Outlet / Seal	Various (see options)

Options

450 mm clamp band lid, 450 mm arag lid
 Valve outlet options including Mucon and Slide
 Full fork tunnels on frame (maximum handling stability)
 Venting / anti-vac / pressure relief
 Vinyl logos
 Trem card holders
 Complete open top version
 Coloured liner
 Anti-static liner

1 - Linear Medium Density Polyethylene 4- Ethylene Propylene Diene Monomer
 2 - High Density Polyethylene
 3 - Silicone Rubber



Container shown is a DGC 1000-60° fitted with an 14" screw lid lid and a 10" slide valve, without anti-tilts

- A multi-trip silo IBC for the transportation and storage of dry goods
- Steep cone angle; ideal for problematic flowing powders
- 4 way fork lift truck entry
- Designed for stability in storage and transport
- Range of outlet options

Description

The DGC 60° is a reusable silo IBC designed for the transportation and storage of dry goods e.g. powders and granules.

The DGC liner is rotationally moulded in natural UV stabilised linear medium density polyethylene. The polymer has strong resistance to industrial wear and tear. The 60° conical base is designed to provide total discharge of the contents. The liner is supported and protected by a galvanised mild steel frame, providing excellent resistance to the elements. The base of the frame has integral four way fork truck entry with anti-tilts to improve handling efficiency and is stackable.

The liner inlet which is 350mm in diameter has a HDPE² screw cap fitted with an SR³ O-ring seal as standard. The vertical outlet at the base of the liner can be specified with a variety of valves to suit individual applications.

DGC 60° Product Range

Type	Volume litres	Dimensions Width/Length/Height mm	Weight Kg
DGC 750-60°	750	1180 / 1180 / 1825	125
DGC 1000-60°	1000	1180 / 1180 / 2050	132
DGC 1250-60°	1250	1180 / 1180 / 2185	138
DGC 1500-60°	1500	1180 / 1180 / 2410	145
DGC 1750-60°	1750	1180 / 1180 / 2632	163
DGC 2000-60°	2000	1180 / 1180 / 2855	170
DGC 2250-60°	2250	1180 / 1180 / 3076	180

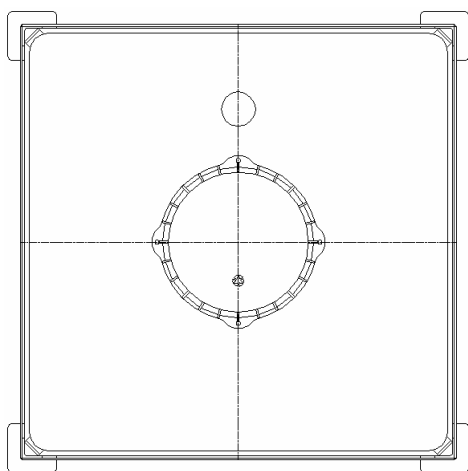

Plan view

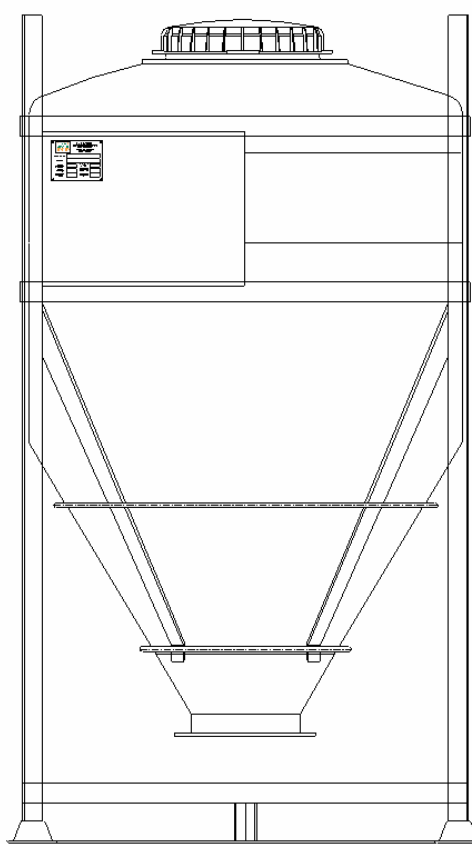

Side elevation

Whilst every attempt has been made to ensure that the information provided in this product information sheet is accurate and reliable Francis Ward Limited cannot accept responsibility for the interpretation of the information provided

It is the responsibility of the user to determine the chemical compatibility of the container with its intended contents..



Francis Ward Limited

Brook House, 221 Bowling Back Lane, Bradford, BD4 8SJ, UK

Tel: +44 (0)1274 707030 Fax: +44 (0)1274 724704

Email: sales@francisward.com

Website: www.francisward.com